

Wireless pet immune PIR motion detector

Quick Start Guide

This device is a wireless motion detector equipped with a PIR sensor. It can control the area with the radius up to 12 meters and is able to ignore animals.

It is connected to your wireless security system via the eV1527 protocol, with an effective communication range up to 100 meters without obstacles. The detector can operate up to 2 years from a battery and is designed for indoor use.

In The Box

PIR Detector (with CR2450 battery) x1

Bracket x1

Screws x2

Switch Toggle Tool x1

Quick Start Guide x1

At a Glance

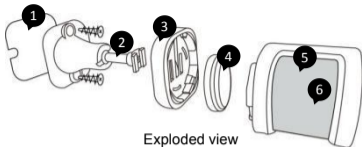

Exploded view

1. **Mounting strip**
2. **Bracket**
3. **Battery receptacle**
4. **CR2450 3V lithium battery**
5. **Motion detect lens**
6. **Light indicator inside:** Blinks for 30 seconds after detector powers on. Lights up when there's a motion is detected in the room. And blinks in the case of low battery, please replace the battery soon.

You can use the toggling tool to toggle the switch.

7. **Power on/off switch:** Slide it to ON to power up the detector.
8. **TEST & NORMAL switch:** To save battery power in NORMAL use, if the detector is triggered twice within 3 minutes, it enters sleeping state immediately. During this period, any movement detected does not generate an alarm. After no movement within the next 3 minutes, it goes back to working state again. For effective walk testing, slide it to TEST. When walk testing is done, slide it to NORM to save power.

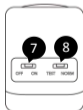

Back view

Detector Location

When selecting the detector installation location, take into account the lens direction and presence of any obstacles impairing the view and radio signal transmission.

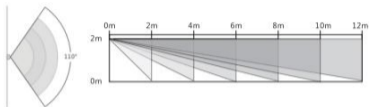

Special Considerations

- Don't install PIR Motion Detector outdoors, in a garage and on the glass.
- PIR Motion Detector can't detect motion through glass, like if someone's moving outside a window.
- Don't install in places where PIR Motion Detector could get wet, like swing-out windows that could be rained on.
- Don't install PIR Motion Detector within 3 feet (1 meter) of a heat source like an electric heater, heat vent or fireplace or another source that may produce turbulent air.
- Don't install PIR Motion Detector behind large appliances or furniture that may obstruct its motion sensors.

Mounting the detector

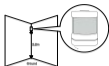

Mounting height:

Motion Detector must be mounted 79 to 87 inches(2 to 2.2m) above the floor.

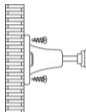

Mount the bracket with the included screws as shown left. Then place the motion detector in the bracket. Specify the right detection range of the motion sensor. Test the operation of the motion detector by putting it into testing mode which has been described at the former page.



Specifications

Power Supply: DC 3V (CR2450 Lithium Battery x1)

Standby Current: <15uA

Alarm Current: <25mA

Detection Scope: <12m/110°

Transmitting Distance: <100m (Open Area and No Interference)

Radio Frequency: 433Mhz

Operation Temperature: -10~55°C